

100
Millimetres

0 10

DO NOT SCALE

SAFETY, HEALTH AND ENVIRONMENTAL
INFORMATION

In addition to the hazards/risks normally associated with the types of work detailed on this drawing, note the following:

CONSTRUCTION

MAINTENANCE/CLEANING

DECOMMISSIONING/DEMOLITION

It is assumed that all works will be carried out by a competent contractor working, where appropriate, to an approved method statement

KEY PLAN:

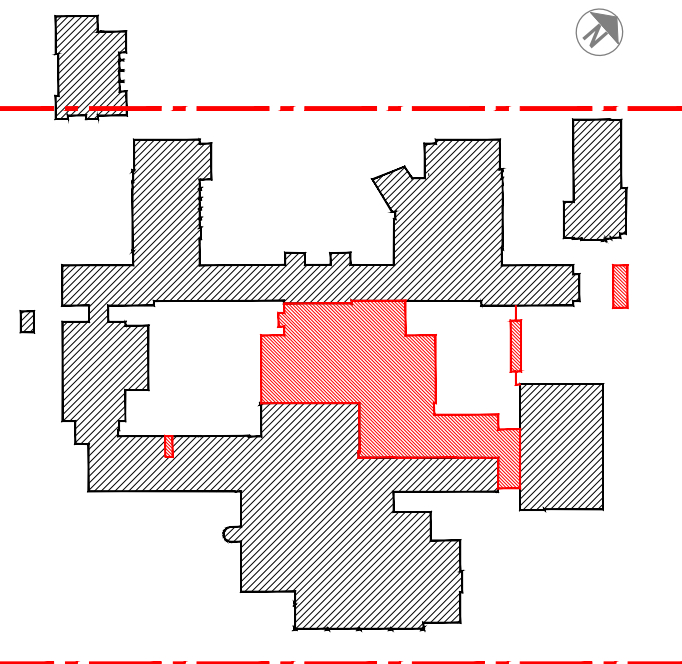

KEY:

- Proposed flat roof
- Proposed rooflight A (1.302x2.216 mm openable)
- Proposed rooflight B (1.302x1.302mm openable)
- Proposed rooflight C (1.302x1.302mm not openable)
- Proposed rooflight
- Proposed natural ventilation turret (drawn indicatively)
- Proposed photovoltaic system location

PL.1	21.07.17	PLANNING ISSUE	LS	JH	RC
Rev.	Date	Description	By	Chk'd	App'd

Drawing Status **FIT FOR PLANNING** Suitability **S7**

ATKINS
4th Floor, The Octagon
27 Middleborough
Colchester, Essex
England
CO1 1TG
Tel: +44 (0)1206 732000
Fax: +44 (0)1206 732020
www.atkinsglobal.com

Copyright © Atkins Limited (2015)
Client



Project Title

**CHESTERTON COMMUNITY
COLLEGE**

Drawing Title

**PROPOSED
ROOF PLAN**

Scale	Designed	Drawn	Checked	Authorised
1:250	JH/LS	LS	JH	RC
Original Size	Date	Date	Date	Date
A1	July 2017	July 217	July 2017	July 2017

Drawing Number **5138389-ATK-Z1-RF-PL-A-4206** Revision **PL.1**

HARD SURFACED
PLAYGROUND

HARD SURFACED
PLAYGROUND

HARD SURFACED
COURT

NEW GATES

LAWN

NEW PAVEMENT

A
A4206
PROPOSED ROOF PLAN
1:250