

\\uk-wsp-prod-01\central_data\Projects\70094243 - Feasibility Studies\70094243-WSP-S1-P04-X-DR-HI-0100_Banned Turns with cycle bypass.dwg 09 Nov 2023 - 11:52am

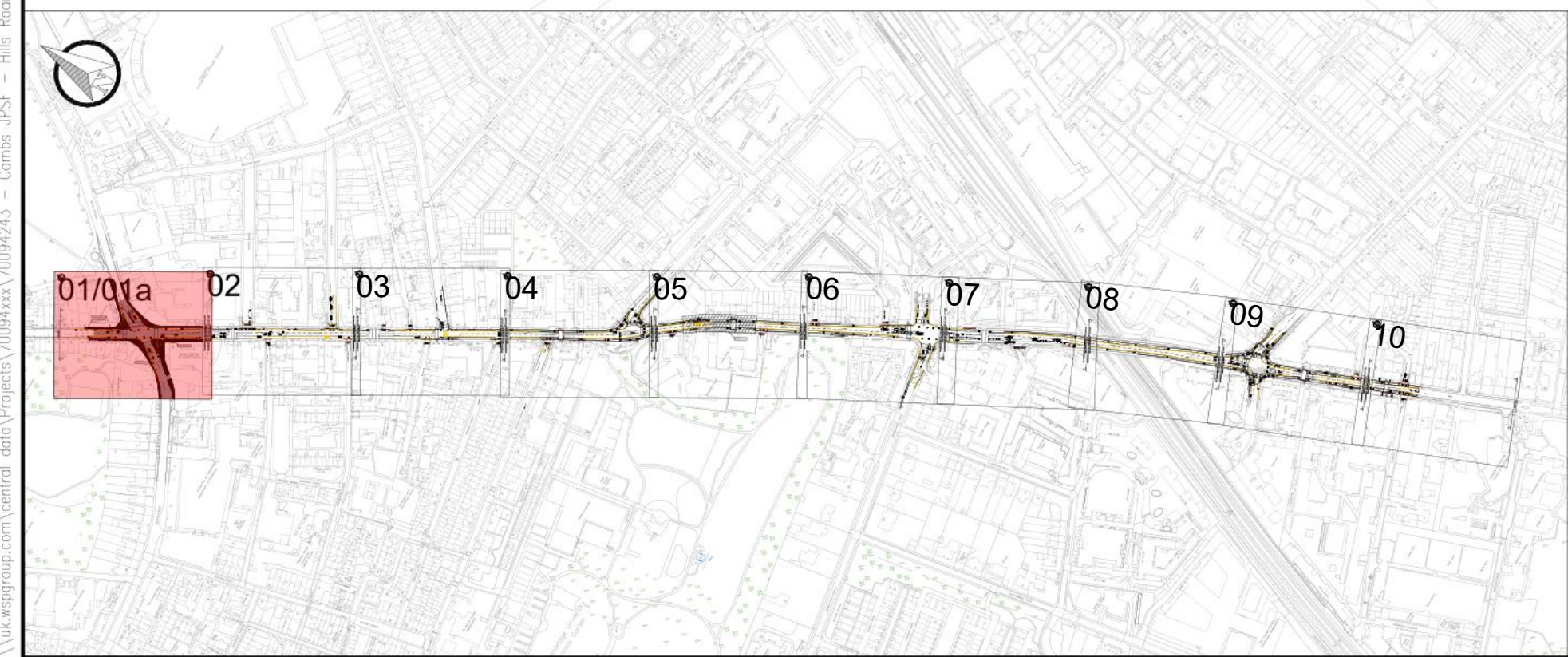

KEY

- PROPOSED YORKSTONE PAVERS
- PROPOSED ASP SLABS
- PROPOSED 200x100mm GREY PRECAST CONCRETE BLOCKS
- PROPOSED 100x100mm COBBLED STONE SETTS BLOCKS
- PROPOSED BELGIAN BLOCKS
- PROPOSED RED ASPHALT SURFACING
- PROPOSED CARRIAGEWAY RESURFACING
- PROPOSED FOOTWAY SURFACE
- PROPOSED PLANTING AREA
- PROPOSED RED TACTILE PAVING
- PROPOSED BUFF TACTILE PAVING
- PROPOSED RAMP
- PROPOSED PRIMROSE YELLOW LINE MARKING
- PROPOSED WHITE LINE MARKING
- PROPOSED FLUSH KERB WITH DROPPER
- PROPOSED KERB
- PROPOSED CAMBRIDGE KERB WITH LOW UPSTAND
- PROPOSED BUS SHELTER
- PROPOSED CYCLE STAND
- EXISTING SERVICE COVER TO BE RELOCATED
- PROPOSED CYCLE LANE WAND
- PROPOSED CORDUROY PAVERS

NOTES:
1) DO NOT SCALE FROM THIS DRAWING.
2) ALL DIMENSIONS ARE IN METRES UNLESS OTHERWISE STATED.
3) THIS DRAWING SHOULD BE READ IN CONJUNCTION WITH ALL RELEVANT DOCUMENTATION, DRAWINGS AND STANDARD DETAILS.
4) DESIGN YET TO BE MODELLED FOR THE IMPACT ON TRAFFIC.
5) WHERE POSSIBLE, THE ROAD WILL HAVE RAISED ENTRY 'COPENHAGEN' CROSSINGS TO IMPROVE PEDESTRIAN MOVEMENTS AND SAFETY OF CYCLISTS.
6) PROPOSED NEW LOADINGS BAYS WILL REQUIRE THE REMOVAL/RELOCATION OF EXISTING PARKING AND CAR CLUB BAYS.

P01	03.11.2023	KLN	FIRST ISSUE	JAH	CL
REV	DATE	BY	DESCRIPTION	CHK	APD

DRAWING STATUS

FEASIBILITY DESIGN

CLIENT

GREATER CAMBRIDGE PARTNERSHIP

PROJECT

HILLS ROAD

TITLE

**GENERAL ARRANGEMENT
SHEET 9a OF 10
CONCEPT DESIGN**

SCALE @ A1
1:250 @ A1

DATE
03.11.23

DESIGN/DRAWN
KLN

CHECKED
JAH

APPROVED
CL

SHEET
A1

WSP PROJECT NO.
70094243

DRAWING NO.
70094243-WSP-S1-P04-X-DR-HI-0100-9a

REV
P01

UNCONTROLLED