



**GREATER
CAMBRIDGE
PARTNERSHIP**

Growing and sharing prosperity

Delivering our City Deal

7 November 2018

To: Members of the Greater Cambridge Partnership Joint Assembly

This is a supplement to the agenda for the **Greater Cambridge Partnership Joint Assembly** meeting taking place on **Thursday 15 November 2018, at 2pm.**

This contains an updated Appendix A(ii) to the Histon Road: Bus, Cycling and Walking Improvements report.

Requests for a large print agenda must be received at least 48 hours before the meeting.

AGENDA

- | | |
|-----------|----------------------------------------------------------------------------------------------------------------------------------------------|
| 8. | Histon Road: Bus, Cycling and Walking Improvements - Final Design – Appendix A(ii)
This updated version contains complete visuals. |
|-----------|----------------------------------------------------------------------------------------------------------------------------------------------|

PAGES
1 - 8

This page is left blank intentionally.

The Junction of Akeman Street – A Green Oasis (with sound track)

Sheet 1 of 2 - Concept Plan and Visualisation

HISTON ROAD LANDSCAPE STRATEGY

Figure 1

OBJECTIVE: build on the opportunity afforded by high footfall to local shops and the bus-stop by providing a new crossing, taking up the asphalt and replacing with soft landscape elements, benches and play equipment to provide recreational and amenity value. Refer to Figure 2 for details of the proposed Rain Gardens.



Key

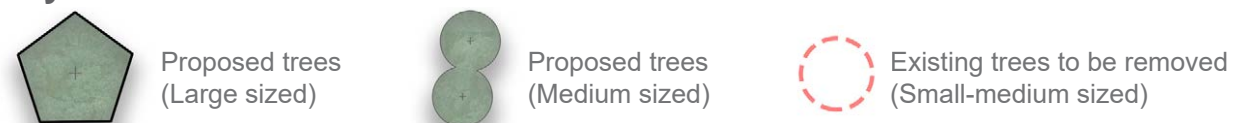

CONCEPT PLAN - Rain Gardens with New / Replacement Tree Planting



VISUALISATION - viewing north-east towards Akeman Street

The Junction of Akeman Street – A Green Oasis (with sound track)

Sheet 2 of 2: Rain Garden Details

DETAIL AREA



KEY PLAN - Refer to Figure 1



Legend

- Marshall's Scoutmoor Yorkstone Paving
- CED Clay Paviers
- Marshall's Tegula Cobbles
- Rain-Garden Planting
- Bench
- Liriodendron tulipifera
- Betula ermanii
- Proposed Dance Chimes Play Equipment

HISTON ROAD LANDSCAPE STRATEGY

Figure 2

PLANTING PHILOSOPHY

A large feature tulip tree with two supporting birch trees will replace the existing poor quality birch trees. The trees are planted in slightly sunken rain gardens which capture surface water runoff and perform a bio-retention function.

The understorey planting includes herbaceous plants, grasses, evergreen structural shrubs, and groundcover plants. The planting / seeding mix will be adapted every five years in response to the changing light conditions beneath the tree canopies and the competition for water and nutrients as tree roots grow.

Adaptive management will be used to ensure any planting or seeding which consistently fails to thrive is replaced with a suitable soft landscape treatment. Bare ground susceptible to footfall and subsequent compaction / erosion will be avoided.

Page 2

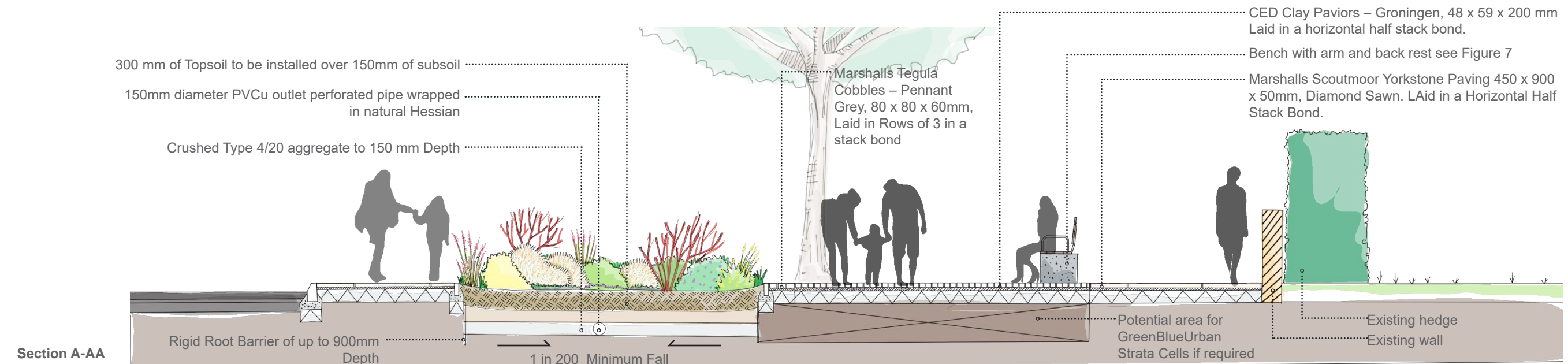

Crossroads At Gilbert Road And Warwick Road – A Gateway Sheet 1 of 2: Concept Plan and Cross Sections

OBJECTIVE: enhance streetscape character by providing a new tree planting design which includes large species with an open canopy. Selected existing small tree species will be replaced to achieve long term environmental, social and economic benefits including biodiversity, improved air quality and reduced surface water runoff.

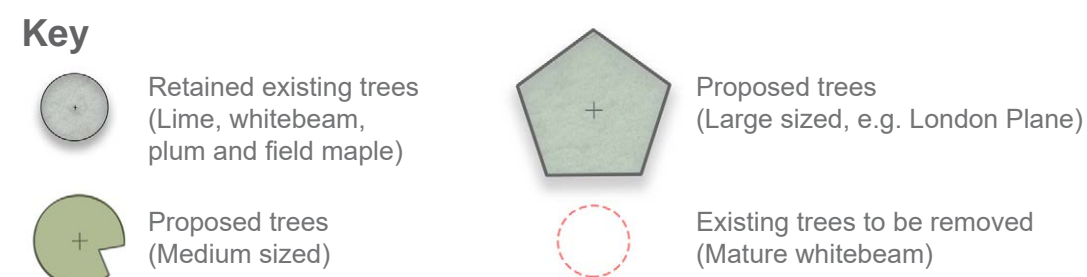

CONCEPT PLAN - New / Replacement Tree Planting

HISTON ROAD LANDSCAPE STRATEGY

Figure 3

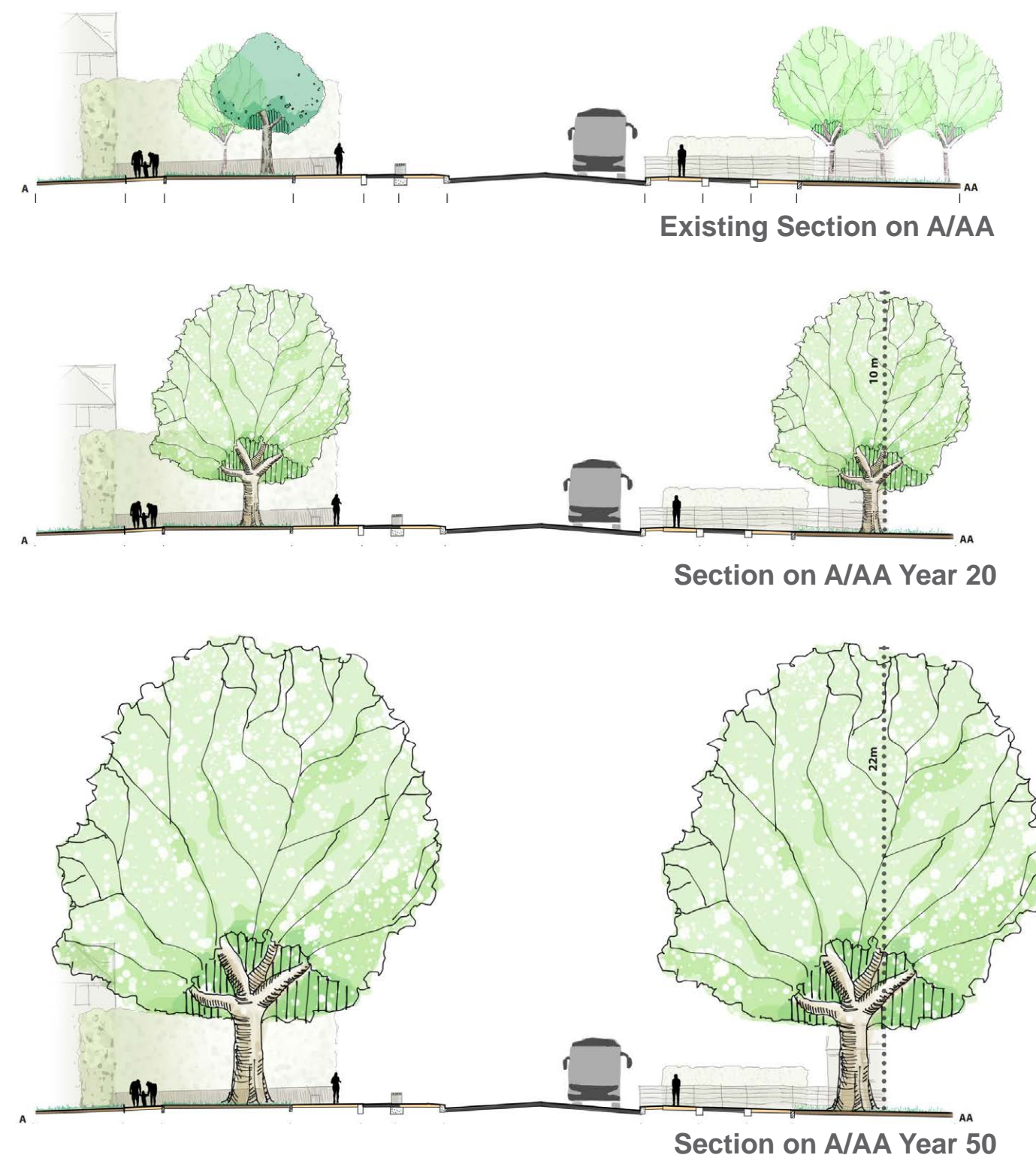

CROSS SECTIONS - Expected Growth Rate of London Plane Trees

Crossroads At Gilbert Road And Warwick Road – A Gateway

Sheet 2 of 2: Visualisation

HISTON ROAD LANDSCAPE STRATEGY

Figure 4



Page 4

VISUALISATION - Viewing north-east across Histon Road towards Langham House

Brownlow Road and Blackhall Road - Birch Trees

OBJECTIVE: the existing mature birch trees in grassed areas are in reasonable condition and provide suitable character and sufficient benefit to the local area. Removal of three mature birch trees at Blackhall Road is proposed to accommodate the bus, cycle and walking improvements. Three replacement birch trees will be planted. There will be a slight reduction in the size of the grassed area at Brownlow road but no tree loss is anticipated.

HISTON ROAD LANDSCAPE STRATEGY

Figure 5



Page 5

Key

- Existing birch trees to be removed
- Retained existing birch trees
- Proposed birch trees

CONCEPT PLAN - Blackhall Road New / Replacement Planting of Birch



EXISTING SITUATION - Brownlow Road No Tree Loss Anticipated

Replacement Planting opposite Hazelwood Close

HISTON ROAD LANDSCAPE STRATEGY

Figure 6

CROSS SECTION - EXISTING

Section A-AA



CROSS SECTION - PROPOSED: 1.8m Metal Mesh Fence planted with Ivy Verge to be seeded with species rich grass

Section A-AA

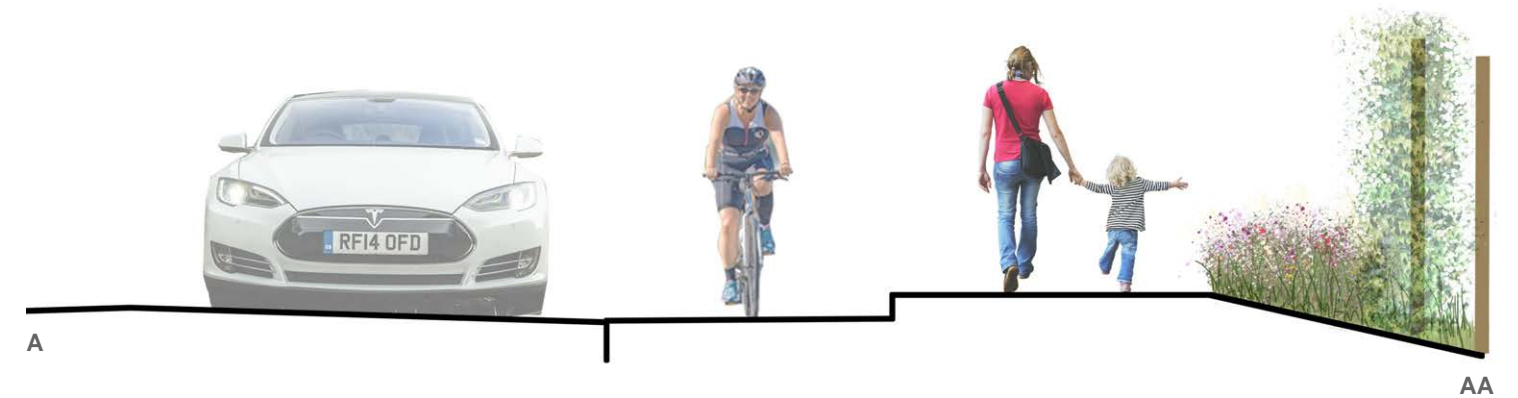

Page 6

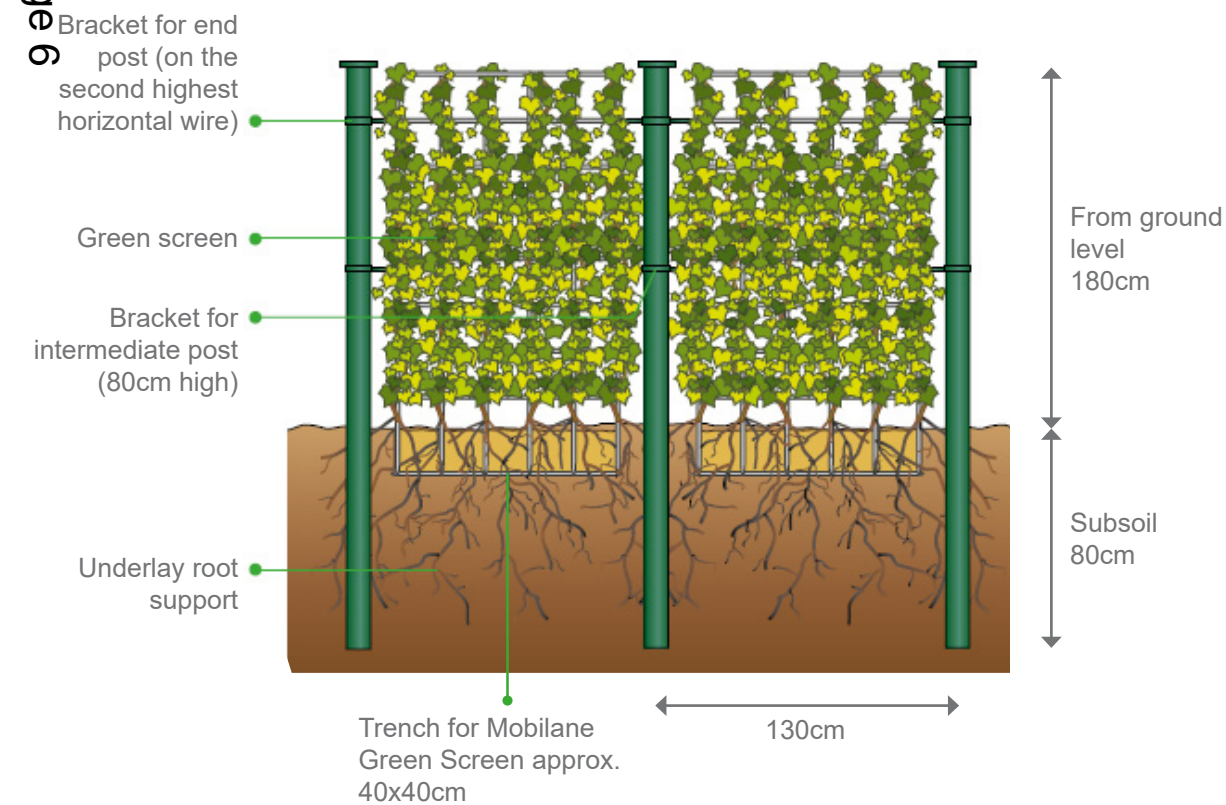

MOBILANE GREEN SCREEN FENCE

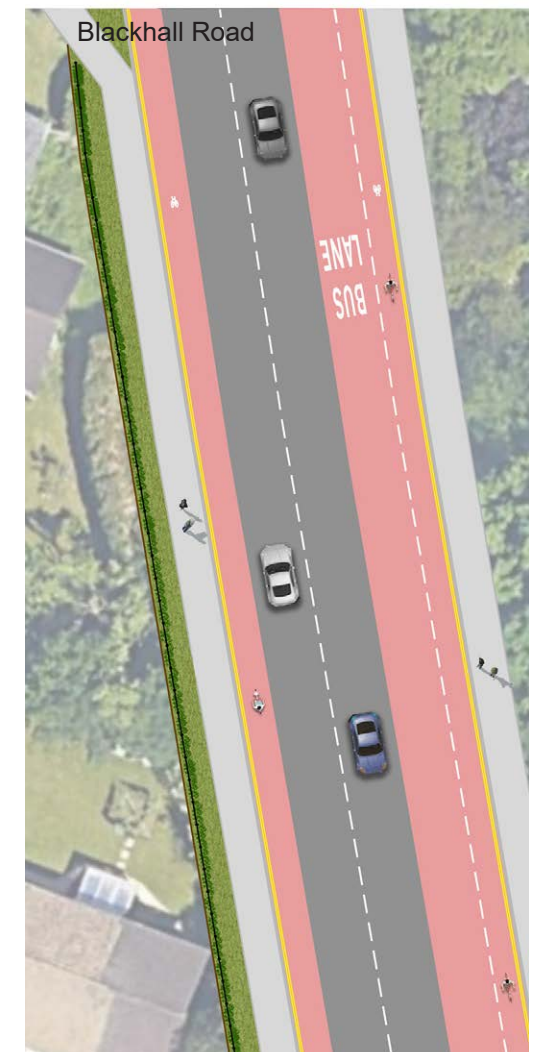
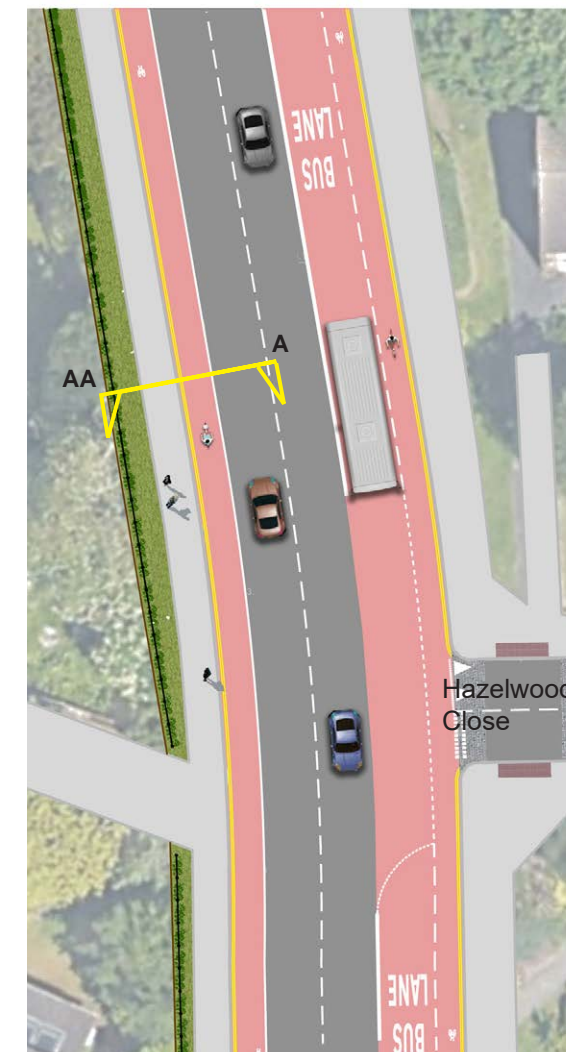
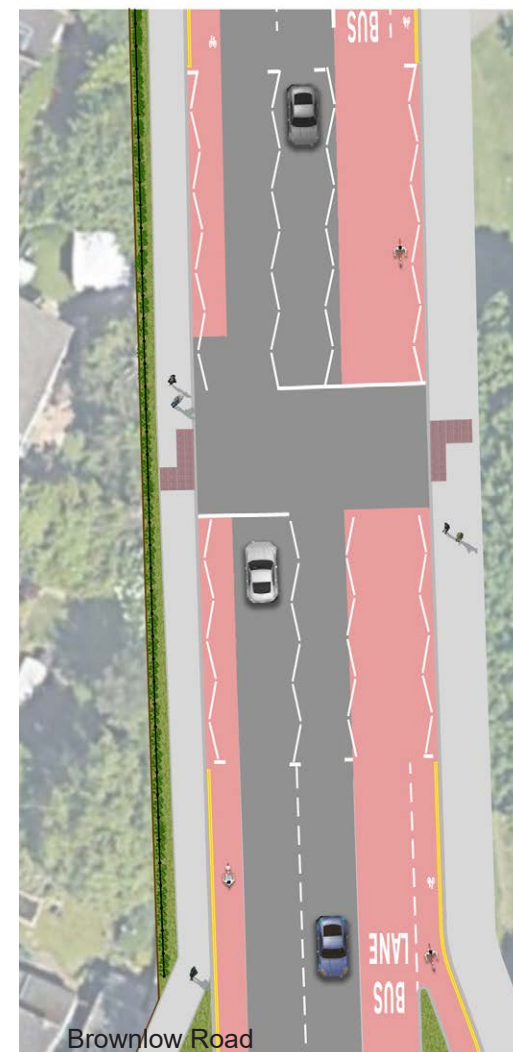

PLANS: Replacement planting and proposed seeding between Brownlow Road and Blackhall Road

Material and Planting Palette

HISTON ROAD LANDSCAPE STRATEGY

Figure 7

Trees



Platanus x hispanica
(London plane)



Liriodendron tulipifera
(Tulip tree)



Betula ermanii
(Gold birch)



Betula pendula
(Birch)



Evergreen Groundcover



Pachysandra terminalis
'Green Carpet'

Flowering Perennials



Geranium 'Orion'



Lysimachia punctata



Veronica longifolia

Shrubs



Cornus alba 'sibirica'



Cornus sanguinea
'midwinter fire'



Hypericum x hidcotense
'Hidcote'

Grasses



Miscanthus sinensis
'Zebrinus'



Calamagrostis x acutiflorus
'Karl Foerster'



Panicum virgatum
'Rehbraun'



Deschampsia cespitosa

Surface Materials



Scoutmoor Yorkstone



Tegula Cobbles



Clay Paviers

Seating



Broxap Parkgate Bench

Play Equipment



Richter Dance Chime

Fencing



Mobilane Green Screen



Hedera varieties

This page is left blank intentionally.