

KEY PLANS:

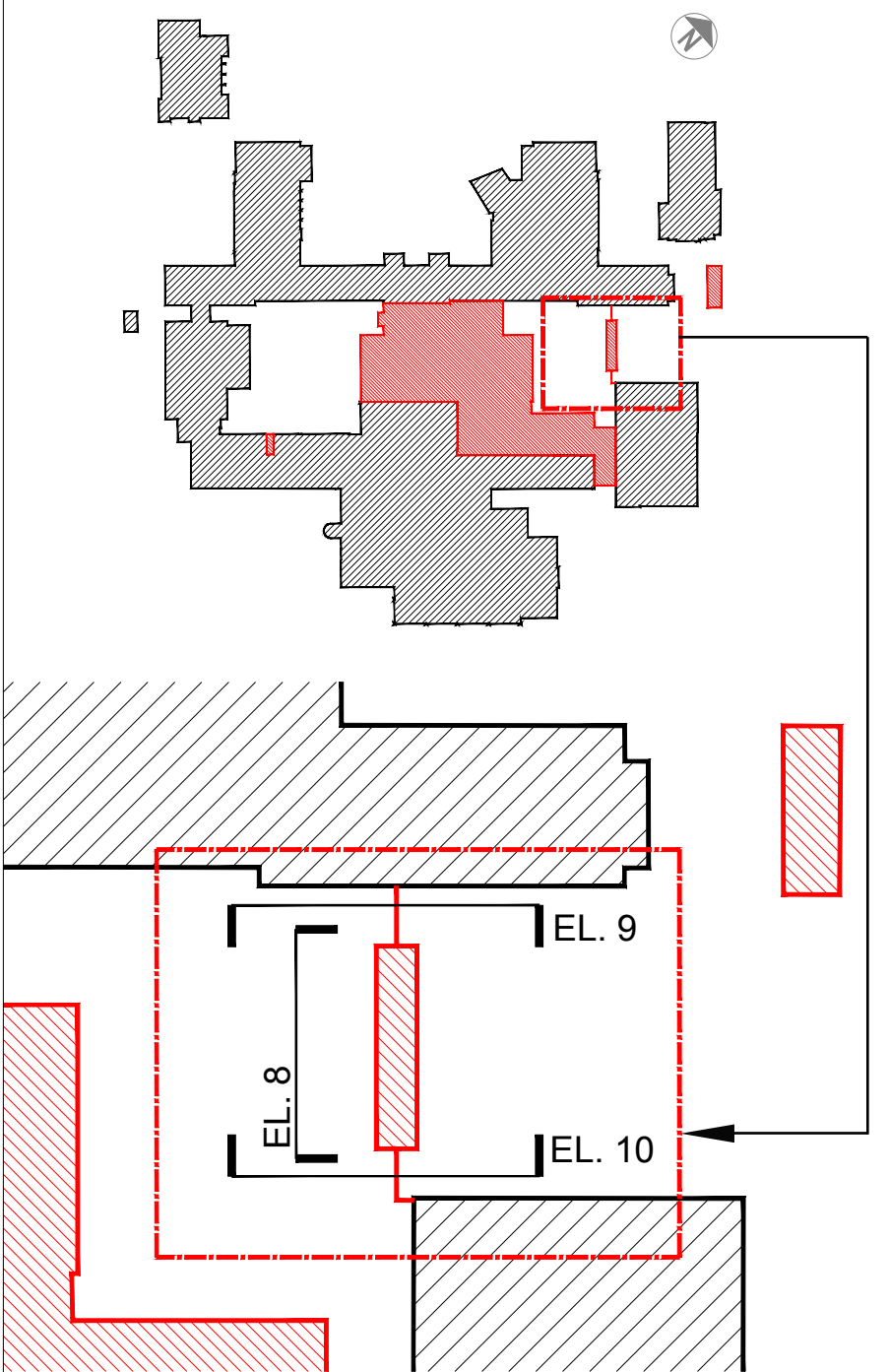

The diagram illustrates an elevation profile with a horizontal datum line at +10,000.00mm. The profile is divided into four sections: EXISTING ELEVATION, PROP. ELEV. (Proposed Elevation), PROPOSED ELEVATION, and PROPOSED SECTION. The EXISTING ELEVATION section shows a downward slope. The PROP. ELEV. section shows a sharp upward step. The PROPOSED ELEVATION section shows a long, relatively flat horizontal segment. The PROPOSED SECTION shows a final upward slope. The vertical axis is labeled 'ELEVATION' and the horizontal axis is labeled 'SECTION'.

Architectural elevation drawing of a two-story building facade. The drawing shows a long, symmetrical facade with multiple windows and a central entrance. A small, modern glass and metal structure is proposed at the entrance. Silhouettes of people are shown for scale. Callouts 04 and 02 point to specific features. A scale bar indicates 0.00mm. The drawing is divided into three sections: EXISTING ELEVATION, PROP. ELEV., and EXISTING ELEVATION.

- Materials:**
01. PPC aluminum parapet capping
  02. Through coloured render on insulation background
  03. PPC double glazed aluminum windows / doors
  04. PPC double glazed curtain walling with integral glazed windows and doors
  05. Rooflight
  06. PPC aluminum louvre door
  07. Facing brickwork
  08. Entrance canopy
  09. PPC double glazed aluminum sloped glazing rooflight system
  10. Insulated PPC aluminum spandrel panels
  11. Through coloured render on existing brickwork
  12. Coloured paint to existing structure
  13. New stainless steel illuminated signage
  14. Cantilevered timber bench
  15. Powder coated galvanised steel gates
  16. Hardwood handrailing
  17. 25mm recessed panel of brickwork

PL.1	21.07.17	PLANNING ISSUE	LS	JH	RC
Rev.	Date	Description	By	Chk'd	App'd

Drawing Status	<b>FIT FOR PLANNING</b>	Suitability	<b>S7</b>
----------------	-------------------------	-------------	-----------

**ATKINS**

4th Floor, The Octagon  
27 Middleborough  
Colchester, Essex  
England  
CO1 1TG

Tel: +44 (0)1206 732000  
Fax: +44 (0)1206 732020  
[www.atkinsglobal.com](http://www.atkinsglobal.com)

Copyright © Atkins Limited (2015)

Client
--------



Project Title	
---------------	--

CHESTERTON COMMUNITY  
COLLEGE

Drawing Title

PROPOSED  
ELEVATIONS / SECTIONS  
Sheet 5 of 7

Scale 1:100	Designed JH	Drawn JH/LS	Checked JH	Authorised RC
Original Size A1	Date July 2017	Date July 2017	Date July 2017	Date July 2017

Drawing Number	Revision
5138389-ATK-Z1-ZZ-EL-A-4304	PL.1