

- KEY**
- Application Area
 - Land Ownership Boundary
 - Proposed Concrete Slab
 - Permitted Concrete Slab
 - Bunding
 - Existing Structures
 - Lagoon
 - Office
 - Biofilter
 - Screening & Storage
 - Weighbridge
 - Office
 - Welfare
 - Weighbridge Office
 - Workshop
 - Biofilter
 - Reception
 - Composting Building
 - Composting Tunnels
 - Maturation
 - Waste Water Treatment Plant

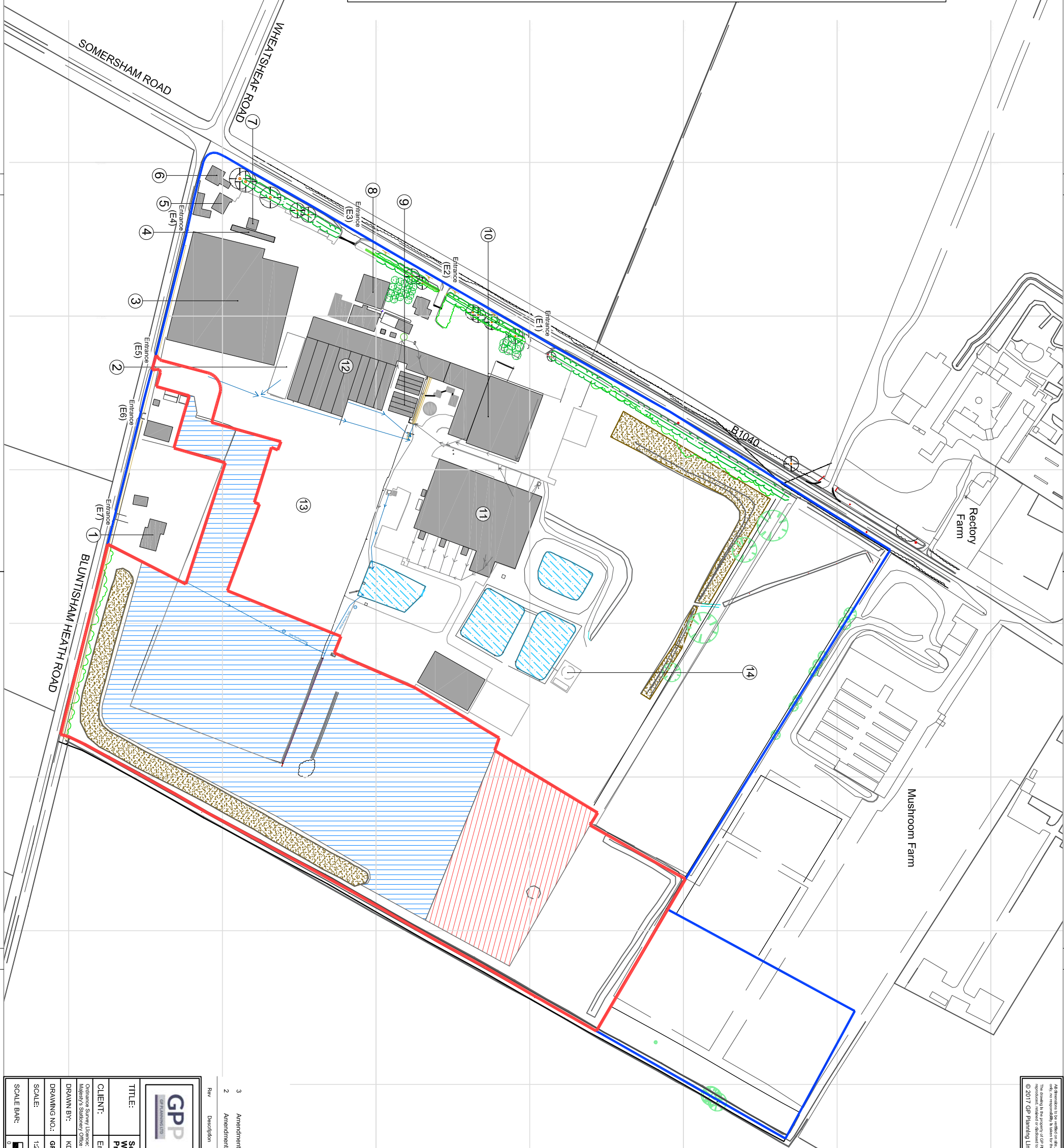

All dimensions to be verified on site. Figure dimensions to data provided to those called. Any areas indicated on this drawing are for guidance only, no responsibility is taken for any accuracy. Copyright is reserved by the author and the drawing is based on the author's data. It is not to be used for any other purpose without the author's written consent. All rights reserved.
© 2017 GP Planning Limited. All rights reserved.

3	Amendment to key (11) labeled Composting Building.	KD	05/06/17
2	Amendment to land ownership boundary to the north.	KD	24/04/17

GP Planning Consultants			
T: 01854 771123 F: 01854 771096 E: info@gpplanning.co.uk The Stables, Long Lane, East Haddon Northamptonshire NN6 8DU Registered in England No. 6013956			
TITLE: Section 73 Application at Chertiffs, The Heath, Woodhurst, Huntingdon PE28 3BS Proposed Site Layout Plan			
CLIENT:	ENVR Limited		
Ordinance Survey Licence: Reproduction from the Ordnance Survey Map with sanction of the Controller of Her Majesty's Stationery Office © Crown Copyright, Licence number 51206551. For identification purposes only.			
DRAWN BY:	KD	CHECKED BY:	TC
DRAWING NO.:	GPP/EN/17/14	REV NO.:	3
SCALE:	1:2500 at A3	DATE:	21 Apr 2017
SCALE BAR:			