

Have your say – September 2011

Babraham Road Park & Ride – proposed extension

Cambridgeshire County Council is proposing to extend the popular Babraham Road Park & Ride and we are keen to hear your views.

Babraham Road Park & Ride is located just south of Cambridge and serves the city centre, The Grafton and the Addenbrooke's Hospital site.

Why is an extension needed?

Babraham Road Park & Ride is the most used of all the Cambridge Park and Ride sites. To continue the success of this site, and the Park & Ride service, it is important that there are enough parking spaces available.

Most weekdays the site is full for about two hours and 90% of spaces are taken for four hours. On weekends, 90% of all spaces are taken for three hours a day.

What are we proposing?

We are planning to add another 500-600 car parking spaces to the current 1000 spaces. General feedback from users of the site includes support for the expansion of the site.

The plan below shows the areas that could be used to extend car parking spaces:

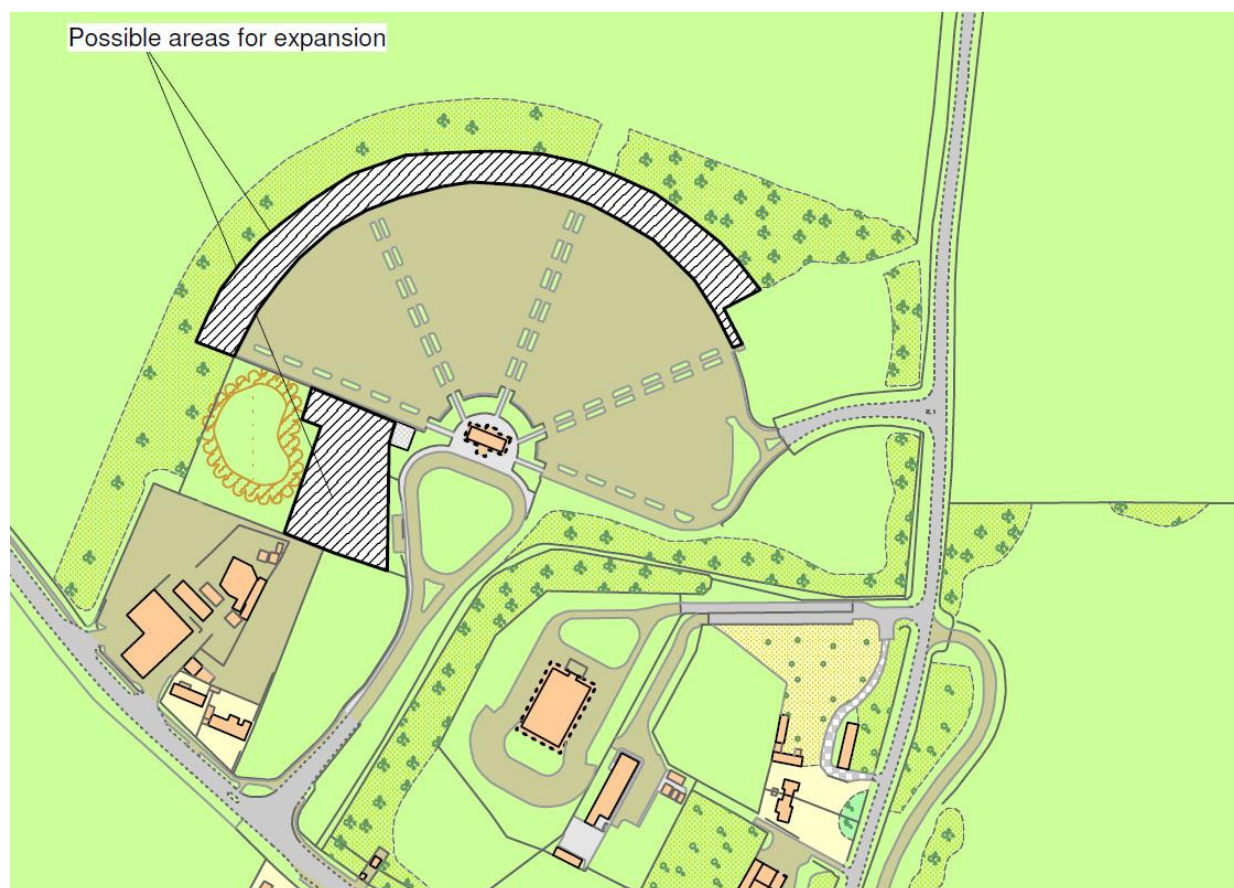

Costs and funding

The extension is estimated to cost £2 million. Funding for this scheme is available through contributions from developers in the area.

Timescales

Babraham Road Park and Ride is within green belt and therefore any expansion is subject to a full planning application process.

The timescales given below are indicative and may be subject to change:

Public consultation	27 Sept – 10 Oct 2011
Seek approval from Cabinet to submit planning application	Oct/Nov 2011
Submit planning application	Nov/Dec 2011
Planning application determined	Jan/Feb 2012
Site clearance	Feb/March 2012
Construction work starts	May/June 2012
Construction completed	Autumn 2012

Whenever possible, construction will take place during the summer months and at times to minimise disruption to users.

YOUR VIEWS

Let us know what you think about the proposed extension of Babraham Road Park & Ride. Please answer the questions below and return this form to the Park & Ride attendant **by Monday, 10 October**.

1. How often do you use Babraham Road Park & Ride?

Most days / weekly / monthly / a few times a year

2. When do you mostly use the site?

Weekdays / weekends / both

3. Where to you usually go to?

City centre / Addenbrooke's / other

4. Do you support the extension proposal in general?

Yes

No

Further information

If you have any queries or need further information, please email transport.delivery@cambridgeshire.gov.uk or call 01223 699906.