

REV	DATE	DESCRIPTION
-	22/11/2019	Issued for Information

**GENERAL NOTES**

- The proposed architectural designs for milestone four (MS4) respond to the Cambridgeshire County Council's Civic Hub design brief document (Aug 2018) and a series of engagement workshops held in Cambridge.
- MS4 Furniture layouts shown indicative. Quantity as per brief. Arrangement to be developed by E390.
- Break out furniture within entrance foyers, meeting rooms and MFR indicative and not included in this study. All TBC.
- To be read in conjunction with MEP/Structure/Acoustic and Fire Engineer's Information.
- Do not scale from this drawing.
- All dimensions to be checked on site by the contractor and as such dimensions to be his responsibility.
- All drawing errors, omissions and discrepancies to be reported to the Architect.
- To be read in conjunction with AHMM NBS specification, Preliminaries and T-sheet Reference.

[illegible]

**NOTE**

When this drawing is issued in uncontrolled CAD format it will be accompanied by a PDF version and is issued to enable the recipient to prepare their own documents / models / drawings for which they are solely responsible.

The recipient should report all drawing errors, omissions and discrepancies to the architect. All dimensions should be checked on site by the contractor and such dimensions shall be the contractor's responsibility.

**Alford Hall Monaghan Morris Limited accepts no responsibility or liability for:-**

- any use of this drawing by parties other than the party for whom it was prepared or for purposes other than those for which it was prepared
- any alterations or additions to or discrepancies arising out of changes to the background information on which the drawings are based that was current at the time of issue, and which occur to that information after it has been issued by AHMM
- any loss or degradation of the information held in this drawing resulting from the use of the drawing from the original file format to any other file format or from the recipient's reading of it in any other programme or any version of the programme other than that which was used to prepare it
- the accuracy of survey information provided by others or for any costs, claims, proceedings or damages of any kind arising out of reliance on such information
- any scaling from this drawing other than by the local planning authority solely for the purposes of the planning application to which it relates

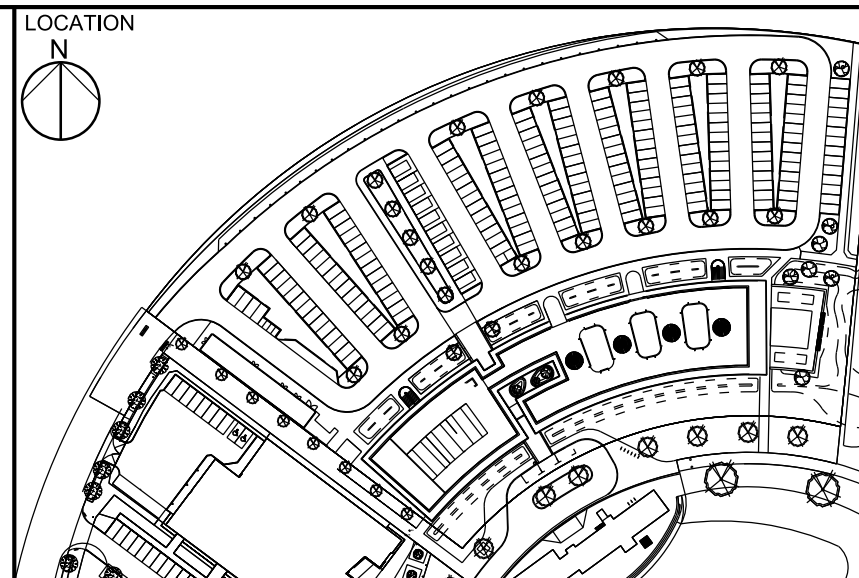

job title Cambridgeshire County Council Alconbury Civic Hub					
drawing title / location GROUND FLOOR PLAN OPTION B2 - 1200X800mm DESKS					
drawn by -	checked -	scale 1 : 200@A1		status INFORMATION	
project 18049	zone A	classification (SK)_72	drawing no.	revision -	



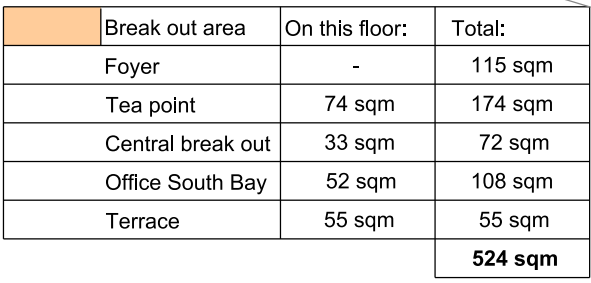

REV	DATE	DESCRIPTION
-	22/11/2019	Issued for Information

- The proposed architectural designs for milestone four (MS4) respond to the Cambridgeshire County Council's Civic Hub design brief document (Aug 2018) and a series of engagement workshops held in Cambridge.
- MS4 Furniture layouts shown indicative. Quantity as per brief. Arrangement to be developed by ESPO
- Break out furniture within entrance foyer, meeting rooms and MFR indicative and not included in this study. All TBC.

- To be read in conjunction with MEP/Structure/Acoustic and Fire Engineer's information.
- Do not scale from this drawing.
- All dimensions to be checked on site by the contractor and as such dimensions to be his responsibility.
- All drawing errors, omissions and discrepancies to be reported to the Architect.
- To be read in conjunction with AHMM NBS specification, Preliminaries and T-sheet Reference.

When this drawing is issued in uncontrolled CAD format it will be accompanied by a PDF version and is issued to enable the recipient to prepare their own documents / models / drawings for which they are solely responsible.

The recipient should report all drawing errors, omissions and discrepancies to the architect. All dimensions should be checked on site by the contractor and such dimensions shall be the contractor's responsibility.

Alford Hall Monaghan Morris Limited accepts no responsibility or liability for:-

- any use of this drawing by parties other than the party for whom it was prepared or for purposes other than those for which it was prepared
- any alterations or additions to or discrepancies arising out of changes to the original information on which the drawings are based that was current at the time of preparation and which changes or discrepancies have been issued by AHMM
- any loss or degradation of the information held in this drawing resulting from the translation from the original file format to any other file format or from the recipients reading of it in any other programme or any version of the programme other than that which was used to prepare it

The accuracy of survey data is not provided by others or for any costs, claims, proceedings or expenses arising out of reliance on such information

- any scaling from this drawing other than by the local planning authority solely for the purposes of the planning application to which it relates



drawn by -	checked -	scale 1 : 200@A1	status INFORMATION	
project 18049	zone A	classification (SK)_73	drawing no.	revision -











Thank you

