

DO NOT SCALE

A1

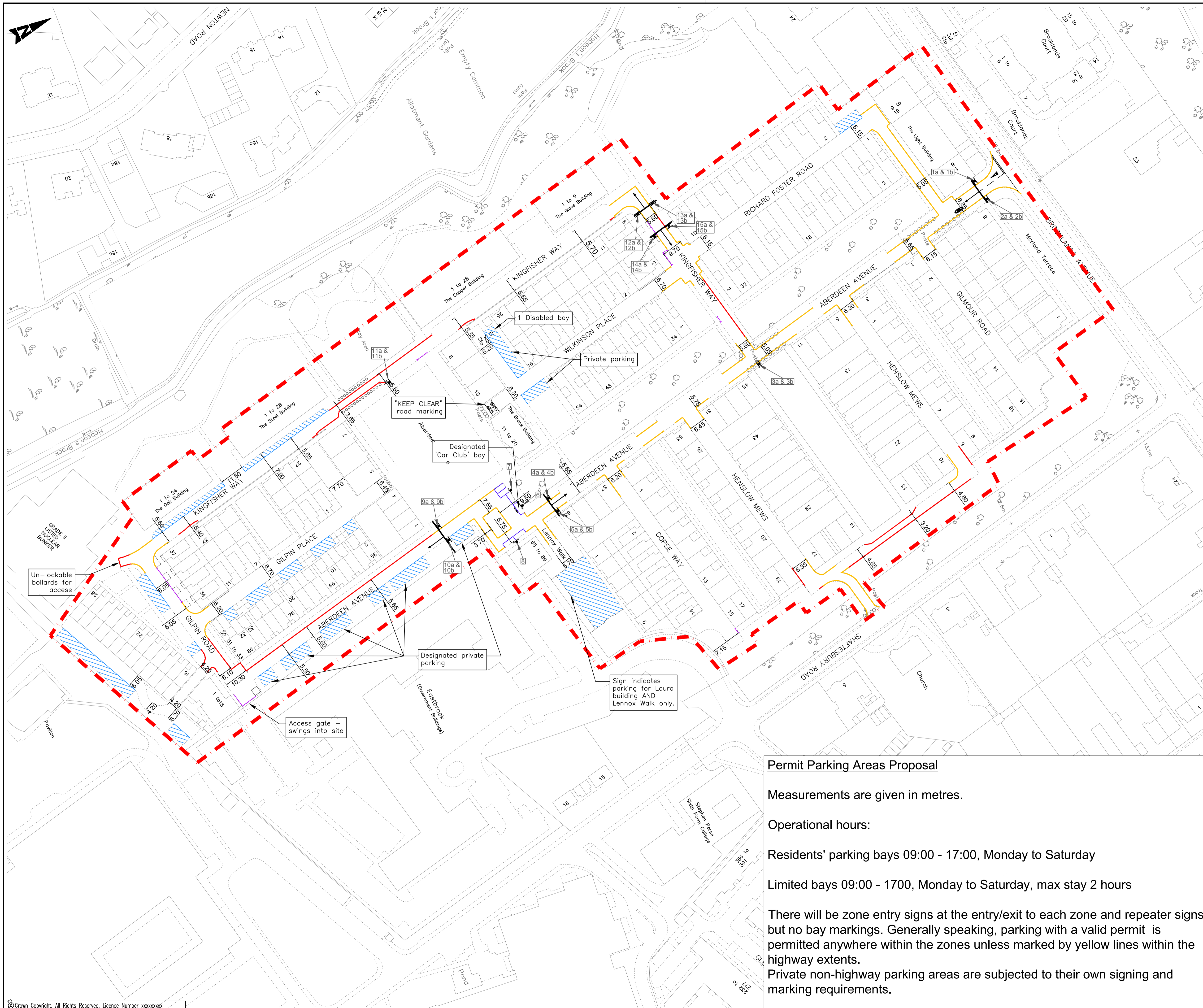

Road	Spaces
Aberdeen Avenue	4 limited waiting & 1 car club

Key	Symbol
Scheme boundary	
Existing double yellow line	
Proposed double yellow line	
Proposed H bar	
Existing designated private parking spaces	
Proposed limited waiting bays	
Sign and post (not actual size)	

SAFETY, HEALTH AND ENVIRONMENTAL INFORMATION

IN ADDITION TO THE HAZARDS/RISKS NORMALLY ASSOCIATED WITH THE TYPES OF WORK DETAILED ON THIS DRAWING, NOTE THE FOLLOWING SIGNIFICANT RESIDUAL RISKS

CONSTRUCTION	(ENTER 'NONE' IF APPLICABLE)
Maintenance/Cleaning	(ENTER 'NONE' IF APPLICABLE)

USE	(ENTER 'NONE' IF APPLICABLE)
Decommissioning/Demolition	(ENTER 'NONE' IF APPLICABLE)

Rev	Description	By	Date	Chk'd	Auth
E	Addition of sign references	NT	02/18		
D	Final amendments	NT	01/18	B-H	B-H
C	Bay counts removed	NT	10/17	B-H	B-H
B	After main stakeholders' meeting	NT	07/17	B-H	B-H
A	After councillors' meeting	B-H	07/17	B-H	B-H

Stat	Purpose of Issue	Date	Auth

Cambridgeshire Highways
 Economy, Transport and Environment
 Highways Service
 Vantage House, Washingley Road
 Huntingdon
 PE29 6SR
 Tel: 0345 045 5212
 local.projects@cambridgeshire.gov.uk



Project: Accordia - PPA Residential Parking Scheme

Title: Proposed Signing and Lining

Original Scale	Designed/Drawn	Checked	Authorised
NTS	NT	AJB-H	AJB-H
Date	06/17	Date 05/10/17	Date 05/10/17

Status	Drawing Number	Rev
C	ACC/GA/101	E

Permit Parking Areas Proposal

Measurements are given in metres.

Operational hours:
 Residents' parking bays 09:00 - 17:00, Monday to Saturday
 Limited bays 09:00 - 17:00, Monday to Saturday, max stay 2 hours

There will be zone entry signs at the entry/exit to each zone and repeater signs, but no bay markings. Generally speaking, parking with a valid permit is permitted anywhere within the zones unless marked by yellow lines within the highway extents. Private non-highway parking areas are subjected to their own signing and marking requirements.