

Cambridge Children's Hospital

Update for Cambridgeshire Adults and Health Committee

14 July 2022

Overview

- **Vision and aims:** Dr Rob Heuschkel, Clinical Co-Lead (CUH) and Nancy Bostock, consultant paediatrician (CPFT)
- **Project update:** Alex White, Project Director
- **Co-production and engagement:** Adrian Lyne, Head of Strategic Engagement (CPFT)
- **Questions**



Our vision: 'A Whole New Way

<https://www.youtube.com/watch?v=TD6Xa2jtkpU>

Case for Change

- **Regional challenge:** Effectiveness and sustainability of Children's services in the region
 - The only region in the country without a dedicated children's hospital
- **Local challenge:** Provision of high quality mental and physical paediatric services in Cambridge
 - Limited integration of mental and physical health impacting consistency of access to services and patient outcomes
 - CAMH access due to rising demand
 - CUH capacity constraints impacting access, occupancy levels and effective patient flows
 - Poor quality of CUH and CPFT estate impacting experience, safety and efficiency
 - No capacity to treat 16-18 year olds within paediatric beds (other than Teenage Cancer Trust beds)
- **National challenge:** Relatively poor UK child health outcomes and costs increasing unsustainably across the NHS
 - Child health outcomes lag behind international comparators (source: RCPCH Child health in 2030, October 2018)

A Whole New Way

- Bringing physical and mental health together
- Child & family at the centre
 - Treat young people as close to home as possible
 - Integrating with community & education
 - Regional specialist care for 1.5m children
- Change the focus of research
 - Early detection and prevention
 - Integrate cutting-edge treatments and technology
- *A whole new way of thinking*

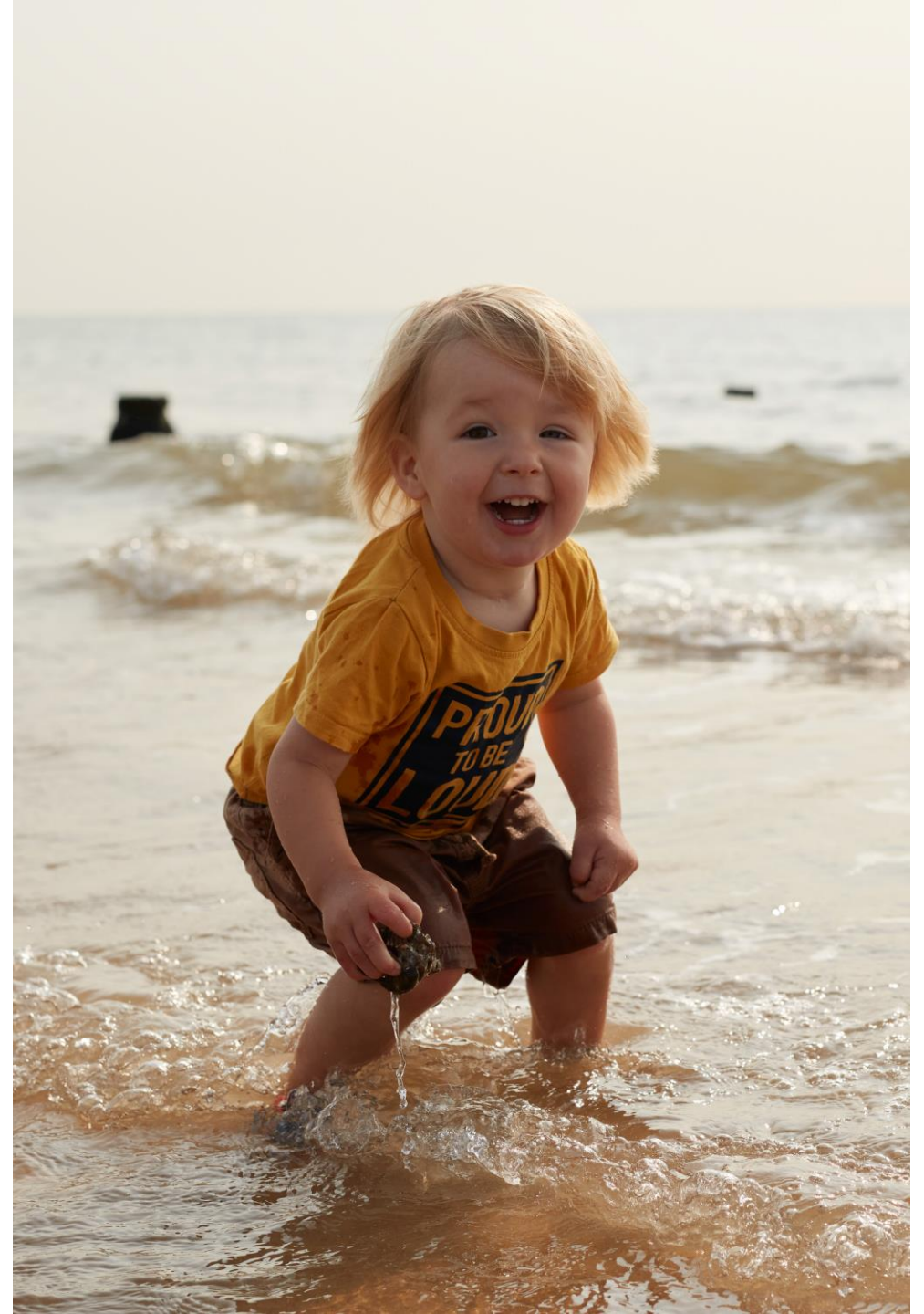

Integrating Mind and Body

- Unique design
 - Shared patient, staff and parent areas
 - Age-based ward integration
 - Dignity – discrete access, sensory rooms,
 - Outside spaces, de-escalation areas
 - Co-design – children & family network
- Approach to Care
 - Shared universal language & training
 - Shared pathways
 - (e.g. eating & feeding, functional disorders)
 - Focus on recovery & community based support



CUH Provision of Regional Services and Outreach for Children in the East of England June 2022

Out of region:

- EACH (East Anglia's Children's Hospices)
- KEECH
- Little Havens Hospice
- Northampton General Hospital - Cleft.Net.East spoke
- Kettering General Hospital - Cleft.Net.East spoke
- Jersey - Urology

Peterborough & Stamford, NWAFT - ODN, PaNDR (Neonatal & Paediatric), Cleft.NET.East spoke, Oncology, Haematology, Endocrinology, Neurology, Gastroenterology, Neurosurgery, Orthodontics, CF Network, ROP, Fetal Med

Hinchingbrooke Hospital, Huntingdon, NWAFT - Neurology, Endocrinology, Gastroenterology, Cardiology, Orthodontics, Palliative care, PaNDR (Neonatal & Paediatric), Neurosurgery, CF Network, ROP, Ophthalmology, Fetal Med

Bedford Hospital - Neurology, Endocrine, Gastroenterology, PaNDR (Neonatal & Paediatric), Neurosurgery, ROP

Luton and Dunstable - Neurology, PaNDR (Neonatal and Paediatric September 2022), Oncology, Haematology, Rheumatology, Cleft.NET.East Spoke, Neurosurgery, ROP

Lister Hospital, Stevenage - Cleft.NET.East in reach, Oncology, Haematology Neurology, Gastroenterology, PaNDR (Neonatal & Paediatric), Neurosurgery, ROP, Fetal Med

Watford General Hospital - Gastroenterology, PaNDR (Neonatal)

Princess Alexandra Hospital, Harlow - Neurology, Ophthalmology, PaNDR (Neonatal and Paediatric), Gastroenterology, Rheumatology, Urology, Surgery, Neurosurgery, ENT, ROP

Basildon & Thurrock - Rheumatology, PaNDR (Neonatal & Paediatric), Neurosurgery, ROP, CHEERS outreach.

Southend Hospital - some Gastroenterology, PaNDR (Neonatal & Paediatric)

Broomfield Hospital, Chelmsford - ODN, PaNDR (Neonatal & Paediatric), some Gastroenterology, Neurosurgery, ROP

Colchester Hospital, ESNEFT - Neurology, Oncology, Haematology, Rheumatology, Ophthalmology, PaNDR (Neonatal & Paediatric), Neurosurgery, ROP, Fetal Med

East of England hosted networks at CUH covering all Trust's:

- CHEERS (Children's East of England Rheumatology Service)
- CF Network
- Cleft.NET.East
- East of England Children & Young People Diabetes Network
- East of England Paediatric Endocrine Network
- East of England Severe Asthma Network
- Major Trauma Network
- Neonatal ODN
- Paediatric Critical Care ODN
- Paediatric Surgery ODN

East of England hosted services at CUH:

- Allogenic / Stem cell transplant
- Brainbow - Brain tumour rehab
- Cardiology
- Clinically Related Excessive Weight Management Service (CREW)
- Dermatology
- East of England Neuro-immunology Service
- Home PN
- Immunology
- LTV
- Neonatal Surgery
- NF2/ ABI (auditory brainstem implants)
- NICU support for the East of England
- Paediatric Post Covid-19 service
- Pain
- Palliative Care
- PICU - the only PICU for the East of England
- Radiotherapy
- Regional Dentistry
- Regional diagnostics
- Regional IVIG service
- Regional MS
- Regional Orthopedics
- Regional Respiratory
- Severe Insulin Resistant Diabetes
- Sleep service
- Stickler

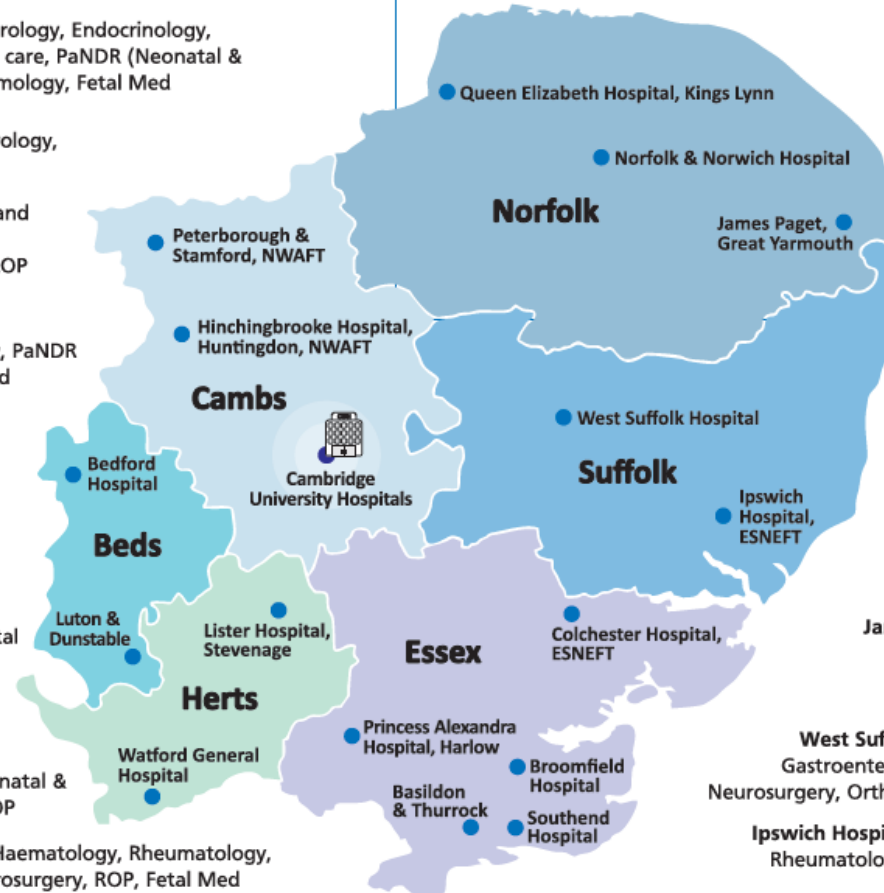

Queen Elizabeth Hospital, Kings Lynn - Neurology, Endocrinology, Ophthalmology, PaNDR (Neonatal & Paediatric), Gastroenterology, Rheumatology, Urology, Surgery, Neurosurgery, ENT, ROP

Norfolk and Norwich - Neurology, Rheumatology, Oncology, Haematology, Cleft.NET.East Spoke, PaNDR (Neonatal & Paediatric), Neurosurgery, ROP

James Paget, Gt Yarmouth - Urology, Rheumatology, Oncology, Haematology, Surgery, PaNDR (Neonatal & Paediatric), Neurosurgery, ROP

West Suffolk Hospital - Urology, Neurology, Endocrinology, Gastroenterology, Cardiology, PaNDR (Neonatal & Paediatric), Neurosurgery, Orthodontics, ROP, Oncology, Haematology, Fetal Med

Ipswich Hospital, ESNEFT - ODN, PaNDR (Neonatal & Paediatric), Rheumatology, Neurology, Oncology, Haematology, Endocrine, Gastroenterology, Neurosurgery, ROP, Fetal Med

Whole Life

Shifting the curve from reactive to preventive medicine, starting at birth

- To show benefits of early diagnosis, prediction of health risk and preventive approaches
- Applied to children to maximize lifelong impact

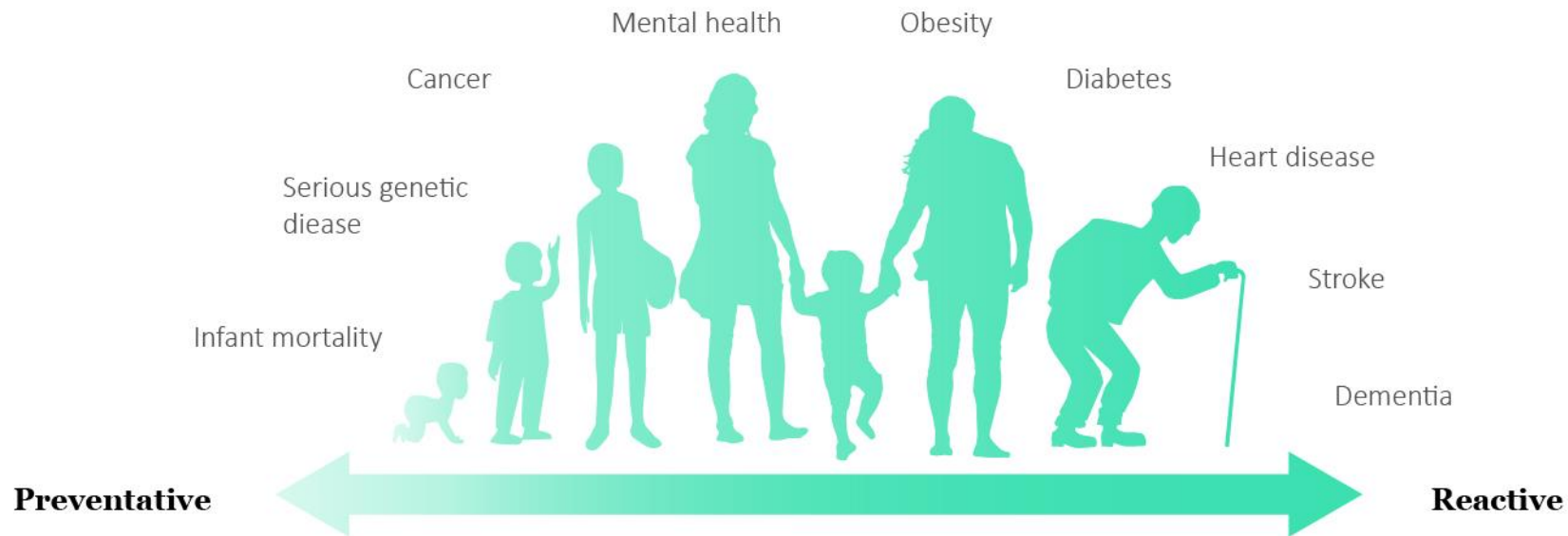

Progress in 2021/22

- Scope of hospital confirmed:
 - 124 inpatient mental and physical health beds
 - 28 day case beds
 - 7 operating theatres
 - Diagnostic imaging (inc. IoMRI, MRI, X-Ray & US)
 - Research space (5,000sqm)
 - School
 - Catering
 - Parent accommodation
- Hospital design completed to RIBA Workstage 2
- Full planning permission granted
- Outline Business Case largely complete
- Philanthropic funding on target
- Digital strategy set out
- Extensive engagement and co-production



Next Steps

- Submission of Outline Business Case (Autumn 2022)
- Next stage of the design (RIBA Workstage 3)
- Service transformation planning
 - Care pathways
 - Workforce modelling
 - Service integration
 - Regional care network
- Digital strategy refinement
- Building contractor procurement
- Full Business Case submission (Autumn 2023)
- Start on site 2024
- Continued engagement and co-production
- Continued fundraising

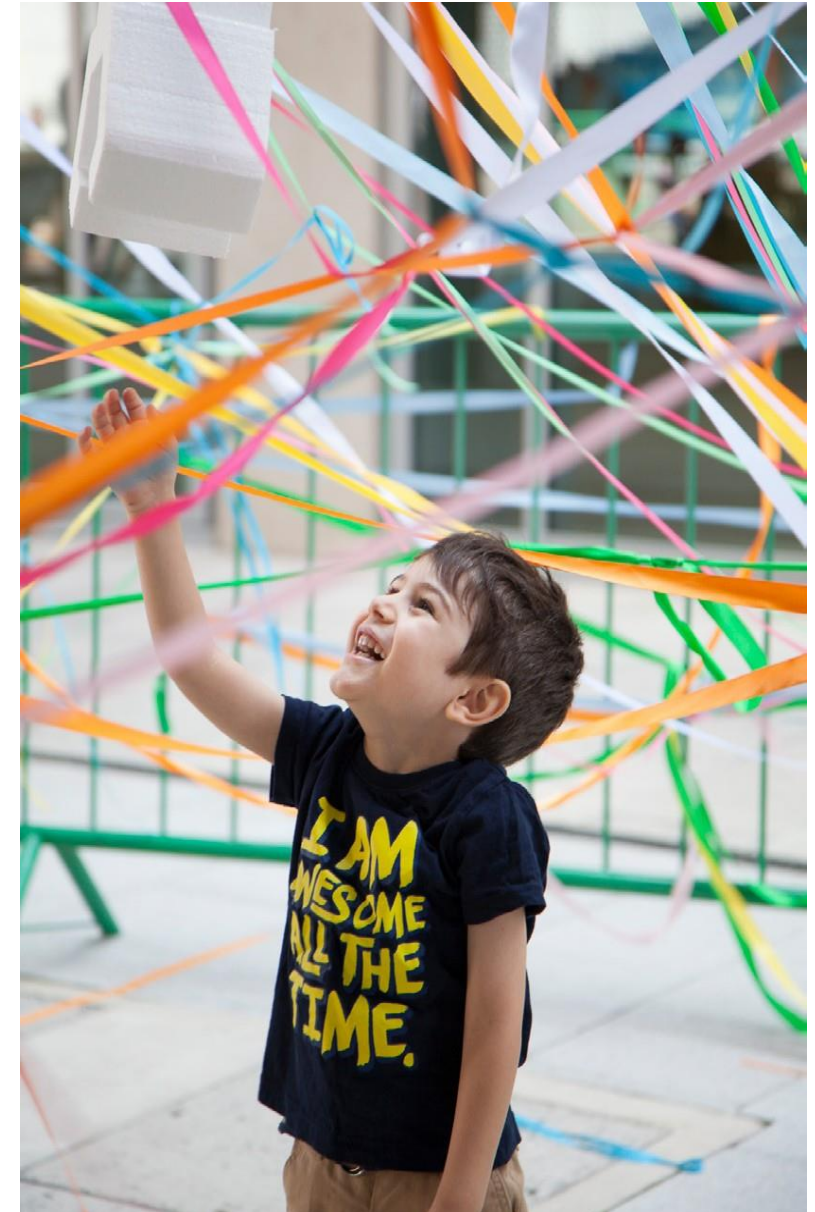

Cambridge Children's Network

- Launched in January 2021
- Brings the voice of children, young people, parents, carers and families to the heart of the project
- Now over 500 members
- People from across the East of England



Patient and Carer Engagement

Since March 2021, we have:

- Run almost **20 workshops**, looking at hospital design, school, wellbeing, digital and art
- Hosted **1-2-1 sessions** with families to better understand their collective experiences
- Recruited **five young people** into our '**Press Pack**' to help develop multi-media content, telling their stories - and ours
- Helped bring young people and families into **the development of research studies** to improve care pathways and using virtual reality to treat anxiety
- Gained insights from **surveys** on the topics of ward design, care pathways and how to better support patients with learning disabilities
- Run an all-day **conference** and a **webinar** about 'Food, with Care' at Cambridge Children's Hospital
- Enjoyed **three face-to-face events**, raising awareness of the project and encouraging involvement



Design Workshops

- Young people on the panel that interviewed and selected the design team. Their input has informed the design development ever since
- Design workshops in 2021 and earlier this year with parents, carers, children and young people in separate sessions.
- All sessions were attended by an illustrator who captured the conversations

“The willingness of the members of each group to share their own personal experience and engage with each topic provided the design team with a rich bed of information to respond to.” - Architect



Colours and Senses

freedom
safety
variety

Kind
calm
care-full
safe

do you think
hospital should
feel like
home?

maybe not home,
but **HOMELY** would
be nice!

WHAT COLOURS
FEEL
HOMELY or SAFE?

yes!

depends

LONG STAY SHORT STAY

Textures
a sense of

WELCOME!

"Somewhere you can be yourself"

CCH Conversation Beach
Engagement Session 4
6-7-21 CG



Cambridge Children's Hospital

21

'Sensitive spaces & zones - suitable for different ages/abilities/siblings...'



'Open spaces to play, breathe, rest.'

'Connection to nature'.
Natural light, natural materials -
appeal to all the senses - even smell.'

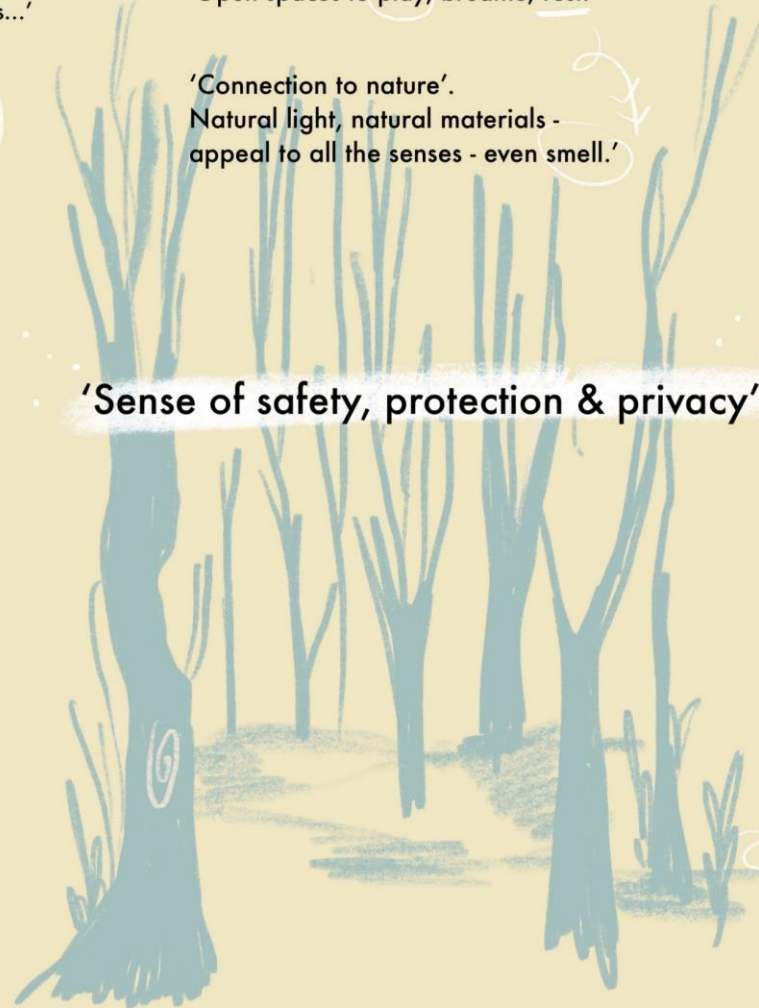

'Sense of safety, protection & privacy'

22



'A touch of normality. Non clinical.'

23



X



'Don't want to say 'no' a lot ...'



*“Play is second
only to staff”*

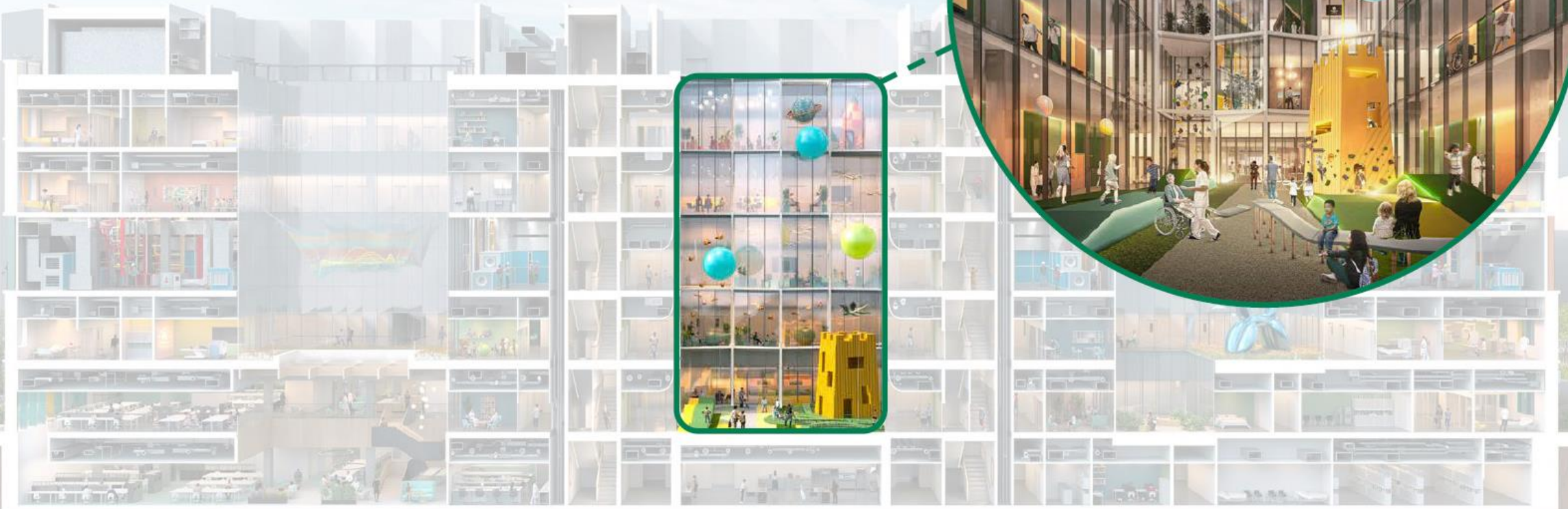





*“Everyone is nervous
and nature would be
good as it is calming
and peaceful”*



*“Colour
everywhere!”*





"Places to be a family"

*“Welcoming,
not scary and
intimidating”*



Being involved in a design workshop, Tristan, 11

<https://www.youtube.com/watch?v=iTEjHYDTA8I>

School Workshops

- Workshops in Autumn last year with young children, young people, parents and carers
- Artist facilitated the session, using materials that were posted out to participants
- Participants said art helped them vocalise their thoughts and experiences
- Arts based engagement with under 7s underway



Long, twisty road on the journey between hospital and back to community school.



“He’s been really engaged and really been thinking. I’ve been amazed!”

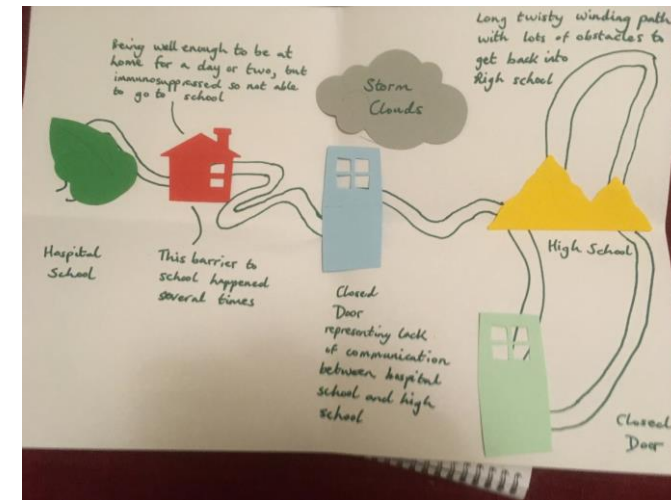

“The hand at the end represents me being pushed and pulled, in and out of school.”

Press Pack

- Five young people in our Press Pack, aged 13-17.
- Most have significant experience of being in hospital for either physical or mental health conditions
- Met Duke and Duchess of Cambridge at County Day

Develop creative content

Learn interview techniques

Give us feedback

Tell your story

Clinician interviews

Interview friends, family and each other!

Present at workstream meetings

Teamwork

Personal and professional development

Confidence



Press Pack members, Sarah and Alisha

https://www.youtube.com/watch?v=eS7lxYJ4m_M

Co-production Champions

- We have **12 parent/carer Co-production Champions** embedded into the project workstreams
- All have lived experience of caring for a child or young person in hospital and/or mental health services

They advise, challenge and collaborate with us, as equal partners, on:

- Development of the integrated model of care (integration of physical and mental health)
- Digital
- Food
- School, including SEND
- Wellbeing learning hub

Plans to build on engagement with children and young people, to develop a Young People's Forum, with representation across the region



Integrated Model of Care

“Integrated care would make things happen quicker with fewer wrong turns before diagnosis. Lack of joined up thinking can cause huge distress.”

“Mental health support should be offered from the start, as we received it way down the line when all the problems were huge for our poorly child. Sibling support is also needed. We wanted people to ask - are you okay?”

“...my daughter’s treatment during these visits met her physical needs but did not adequately explore the cause of or treat her poor mental health. I think it’s important to re-think how we approach young adults with mental health conditions in the Children’s Hospital to ensure they don’t fall between the gaps...”



“Our GP didn't recognise that my child was in mental health crisis. Recognition between the support services that help is often needed immediately.”

Co-production Champions experiences

<https://www.youtube.com/watch?v=o5XrpkEjBSk>